

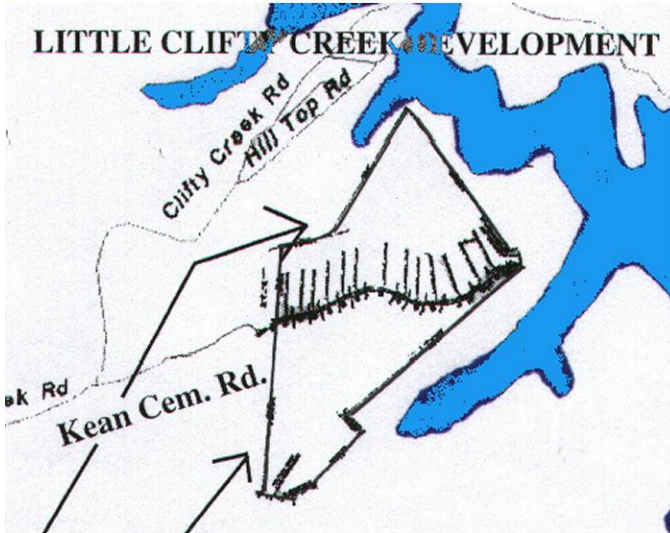

Listing #R-105- Kean Cemetary Road, Jamestown, KY 42629



LAKE ORIENTED PROPERTY FOR DEVELOPMENT OR PRIVATE RETREAT OFF SOUTH HWY. 127

(near the up-coming Jamestown by-pass) BETWEEN LURE LODGE (LAKE CUMBERLAND STATE RESORT PARK) AND LITTLE CLIFTY DEVELOPMENT ON LAKE CUMBERLAND.

64 ACRES, M/L, FROM NEW SURVEY. PRIVATE, WITH GOVERNMENT BOUNDARY LINES 1/2 OF THE WAY AROUND PROPERTY. ALL WOODED WITH LOG COUNTY RD. FRONTAGE. JUST A SHORT WALK TO THE LAKE W/ POSSIBLE VIEW. APPROXIMATELY 75% LAYS MOSTLY LEVEL.

ELECTRICITY ACROSS PROPERTY WITH COUNTY WATER NEARBY. A GREAT PLACE FOR INTERIOR LAKE. TERMS AVAILABLE. CALL TODAY! Agent owned.

***List Price: \$3,500 Per Acre**

Call Today To Make Your Appointment For Viewing!



For More Information Contact A Friendly Golden Rule-Wilson Representative:

Columbia Office: 1-270-384-1111 or 1-800-854-9992

Russell Springs Office: 1-270-866-6600 or 1-800-410-5155



For Location Map & Directions Visit This Listing Online At: www.goldenruleauction.com

*List price, specifications, & availability are subject to change without notice.

Disclaimer: All information is believed to be correct but is not warranted by selling agents.